



SPRAY CHARACTERISTICS

- Asymmetric flat spray pattern with spray projected to the side.
- Spray density decreasing from heavy upper edge to give uniform ground contact.

CONSTRUCTION AND MATERIALS

- Type LX is of 3 piece construction.
- Straight through elliptical orifice with no internal vanes or cores.
- Optional body, cap and strainer available in a variety of thread sizes.
- Thread sizes are Male BSPT and Female BSPP.
- Specialised bodies are also available.
- Available in Brass and Stainless Steel.

ORDER EXAMPLE

LX 12 Brass = Tip Only.

3/8" LXF (Female) 10 Brass = Complete Assembly.

DIMENSIONS AND WEIGHTS

Thread Size	Assembly Type	Dimensions (mm)			Weight (g)
		A Hex	B	C Hex	
1/4	LXM	20,8	46,0	18,0	68
1/4	LXF	20,8	46,0	18,0	61
3/8	LXM	20,8	46,0	18,0	69
3/8	LXF	20,8	46,0	20,8	63

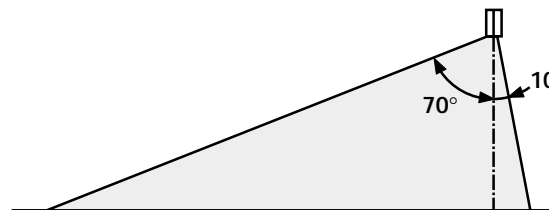

TYPICAL SPRAY PATTERN @ 2.8 Bar.G.

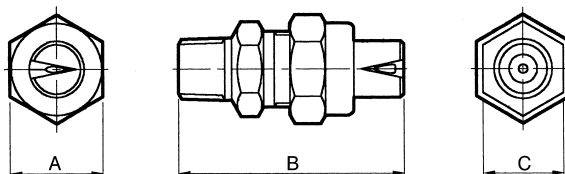

LXM (MALE) ASSEMBLY

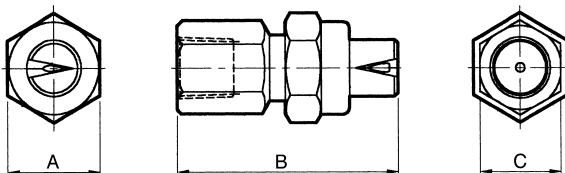

LXF (FEMALE) ASSEMBLY

Maximum Recommended Pressure: 70 Bar.G.

CAPACITY CHART

NOZZLE NUMBER	RECOMMENDED THREAD SIZE		Equiv Orifice Dia. (mm)	FLOW CAPACITY IN LITRES/MIN AT Bar.G.					
	1/4	3/8		1	2	3	4	5	7
LX 2			0,9	0,46	0,64	0,79	0,91	1,02	1,21
LX 3			1,1	0,69	0,97	1,18	1,37	1,52	1,80
LX 4			1,25	0,91	1,29	1,58	1,82	2,04	2,41
LX 6			1,5	1,37	1,93	2,37	2,73	3,06	3,62
LX 8			1,75	1,83	2,58	3,16	3,65	4,08	4,83
LX 12			2,15	2,74	3,87	4,74	5,47	6,12	7,24
LX 16			2,5	3,65	5,16	6,32	7,29	8,16	9,65

Contact our Helpline for any special requirements:
Tel: +44 (0) 151 424 6821
Fax: +44 (0) 151 495 1043
e-mail: sales@delavan.co.uk
Web: www.delavan.co.uk

